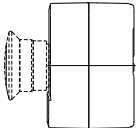
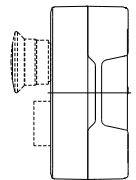
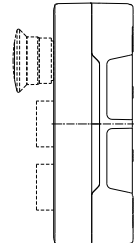

General	Control Stations & Enclosures
	<p>These are plastic series Control Stations available from 1way to 6way. They are in two forms:</p> <ul style="list-style-type: none"> <li>• Complete</li> <li>• For customer assembly</li> </ul> <p>These control stations use plastic bezel pushbuttons, switches &amp; pilot lights, which offers a wide choice of circular &amp; square type of actuators.</p> <p>The following can be assembled in these control stations:</p> <ol style="list-style-type: none"> <li>1. Actuators from series P2PS, non-illuminated, with contacts blocks from regular series S... or from clip-on series C... (Cover mounting &amp; base mounting).</li> <li>2. Head from series P2PL along with clip type lamp (LED)</li> <li>3. Mono-block Pushbuttons from 3PS... series &amp; pilot lights from 3PL... series</li> </ol>
Complete Stations	Pre-assembled
	<p>These are complete, ready to install, stations fitted with 1 to 3 buttons to cater for the most commonly encountered functions e.g.</p>
	<p>1.0 Emergency Stop, with:</p> <ul style="list-style-type: none"> <li>• 1 red, push to stop, turn to release, mushroom head pushbutton</li> </ul> <p><u>Product Codes:</u></p> <p>4008A10 1way modular station (ABS) with yellow cover &amp; black housing with P2PSML401 pushbutton</p> <p>4009A10 1way modular station (PC) with yellow cover &amp; black housing with P2PSML401 pushbutton</p>
	<p>2.0 Start or Stop, with:</p> <ul style="list-style-type: none"> <li>• 1 flush spring return pushbutton,</li> <li>• 1 red, push to stop, turn to release, mushroom head pushbutton</li> </ul> <p><u>Product Codes:</u></p> <p>4008C10 2way modular station (ABS) with yellow cover &amp; black housing P2PSF310 &amp; P2PSML401 pushbuttons</p> <p>4009C10 2way modular station (PC) with P2PSF310 &amp; P2PSML401 pushbuttons</p> <p>4010C10 2way modular station (ABS) with white cover &amp; black housing with P2PSF310 &amp; P2PSML401</p> <p>4011C10 2way modular station (PC) with white cover &amp; black housing with P2PSF310 &amp; P2PSML401</p> <p>4012C10 2way modular station (ABS) with grey cover &amp; housing with P2PSF310 &amp; P2PSML401</p>
	<p>3.0 Start or Stop, with:</p> <ul style="list-style-type: none"> <li>• 2 flush spring return pushbutton,</li> <li>• 1 red, push to stop, turn to release, mushroom head pushbutton</li> </ul> <p><u>Product Codes:</u></p> <p>4008E10 3way modular (ABS) station with yellow cover &amp; black housing with P2PSF310, P2PSF401 &amp; P2PSML401 pushbuttons</p> <p>4009E10 3way modular (PC) station with yellow cover &amp; black housing with P2PSF310, P2PSF401 &amp; P2PSML401 pushbuttons</p> <p>4010E10 3way modular (ABS) station with white cover &amp; black housing with P2PSF310, P2PSF401 &amp; P2PSML401</p> <p>4011E10 3way modular (PC) station with white cover &amp; black housing with P2PSF310, P2PSF401 &amp; P2PSML401</p> <p>4012E10 3way modular (ABS) station with grey cover &amp; black housing with P2PSF310, P2PSF401 &amp; P2PSML401</p>
Stations for customer assembly	To be assembled by Customer
	<p>These stations are for assembly by the user &amp; offer a choice of 2 assembly methods:</p> <ul style="list-style-type: none"> <li>• <b>Base Mounting Method</b></li> </ul> <p>The electrical blocks are mounted on a metal mounting plate in the housing of the enclosure.</p> <ul style="list-style-type: none"> <li>• <b>Cover Mounting Method</b></li> </ul> <p>The electrical blocks are mounted directly beneath the heads using a</p>

body/fixing collar.

It is possible to assemble stations with 1 to 6 heads, each of which can be combined with:

- 3 electrical blocks (contact or light) of Clip-on type
- 2 electrical blocks (contact) of S series

The actuator head offers a wide choice of head types such as:

- Spring return (marked or unmarked)
- Spring return twin headed
- Spring return, mushroom head
- Latching mushroom head
- Selector with standard or long handle & key switches

Accessories	For Actuators
-------------	---------------

Legend plate can be made available as per requirement.  
Station guard

Environment	
Ambient air temperature	: -25 to +70°C (storage /operation)
Degree of Protection	: Applied for IP65 as per IEC/EN 60947-1
Conformity to standards	: Applied for testing as per UL 50, UL508 & CAN/CSA C22.2 No. 14-05
Material & colors	: ABS LIGHT GREY RAL 7035 COVER & HOUSING ABS YELLOW COVER & BLACK HOUSING ABS WHITE COVER & BLACK HOUSING POLYCARBONATE YELLOW COVER & BLACK HOUSING POLYCARBONATE WHITE COVER & BLACK HOUSING
Cable entries	: Knock out entries for cable gland PG13.5 & ISO 20

### Dimensions

Note: All dimensions are in mm unless otherwise stated

#### 1way

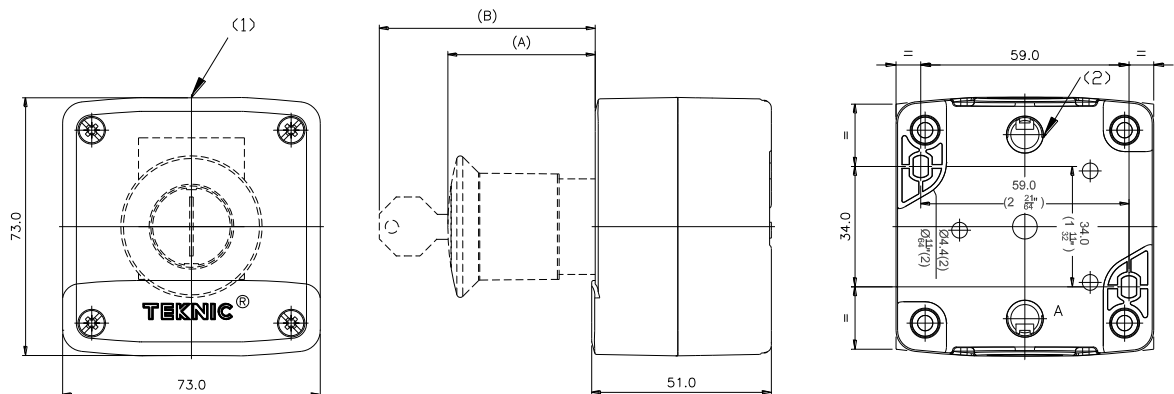

Following variations are available in 1way empty enclosure

Sr. No.	Color of cover	Color of housing	Product code	Remarks
1	White	Black	4003A11	PC
2	Yellow	Black	4004A10	PC
3	White	Black	4005A11	ABS
4	Yellow	Black	4006A10	ABS
5	Grey	Grey	4007A17	ABS

(1) 2 Nos of knockout for PG13.5 cable gland, maximum capacity 12mm

(2) 2 Nos Knockout for cable entry, max capacity 10mm

(A) 51mm (max) for non-illuminated, latching, mushroom head Emergency Stop pushbutton

48mm (max) for non-illuminated, latching, mushroom head, key operated, Emergency Stop pushbutton (with key removed)

(B) 72mm (max) for non-illuminated, latching, mushroom head, key operated, Emergency Stop pushbutton (with key inserted)

#### Dimensions (Contd.)

##### 2way

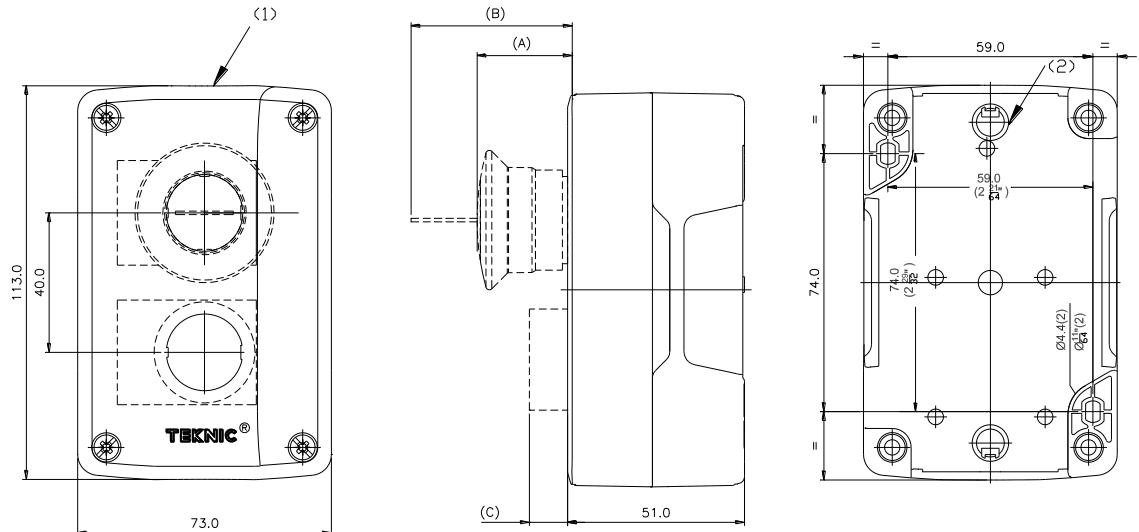

Following variations are available in 2way empty enclosure

Sr. No.	Color of cover	Color of housing	Product code	Remarks
1	White	Black	4003C11	PC
2	Yellow	Black	4004C10	PC
3	White	Black	4005C11	ABS
4	Yellow	Black	4006C10	ABS
5	Grey	Grey	4007C17	ABS

##### 3way

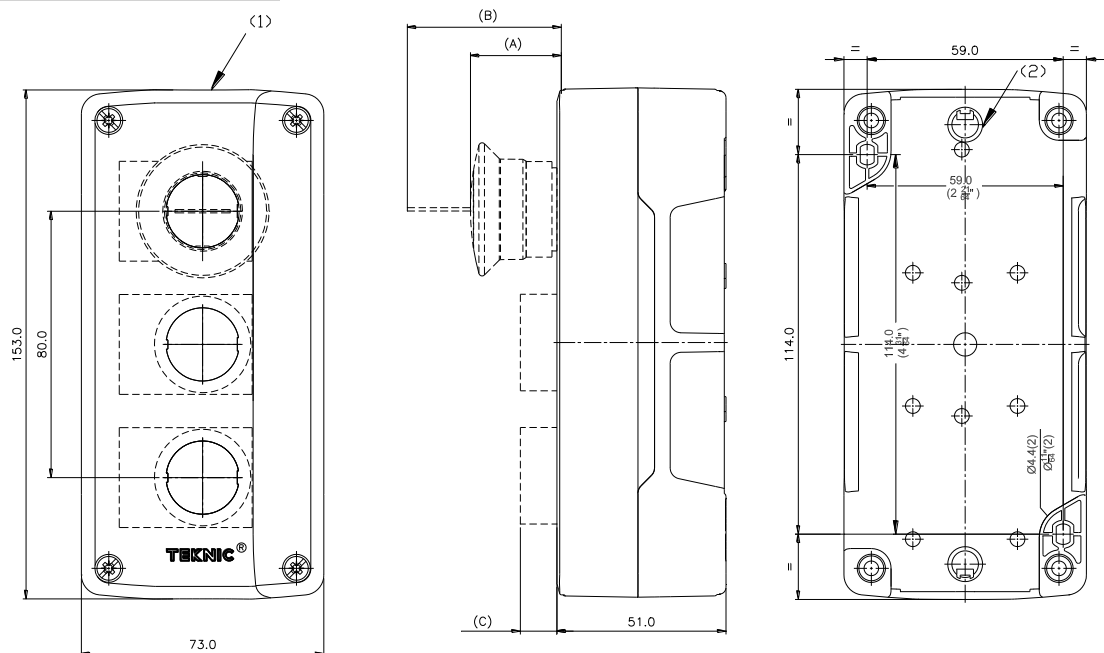

- (1) 2 Nos of knockout for PG13.5 cable gland, maximum capacity 12mm
- (2) 2 Nos of Knockout for cable entry, max capacity 10mm
- (A) 51mm (max) for non-illuminated, latching, mushroom head Emergency Stop pushbutton
- 48mm (max) for non-illuminated, latching, mushroom head, key operated, Emergency Stop pushbutton (with key removed)
- (B) 72mm (max) for non-illuminated, latching, mushroom head, key operated, Emergency Stop pushbutton (with key inserted)

#### Dimensions (Contd.)

Following variations are available in 3way empty enclosure

Sr. No.	Color of cover	Color of housing	Product code	Remarks
1	White	Black	4003E11	PC
2	Yellow	Black	4004E10	PC
3	White	Black	4005E11	ABS
4	Yellow	Black	4006E10	ABS
5	Grey	Grey	4007E17	ABS

#### 4way

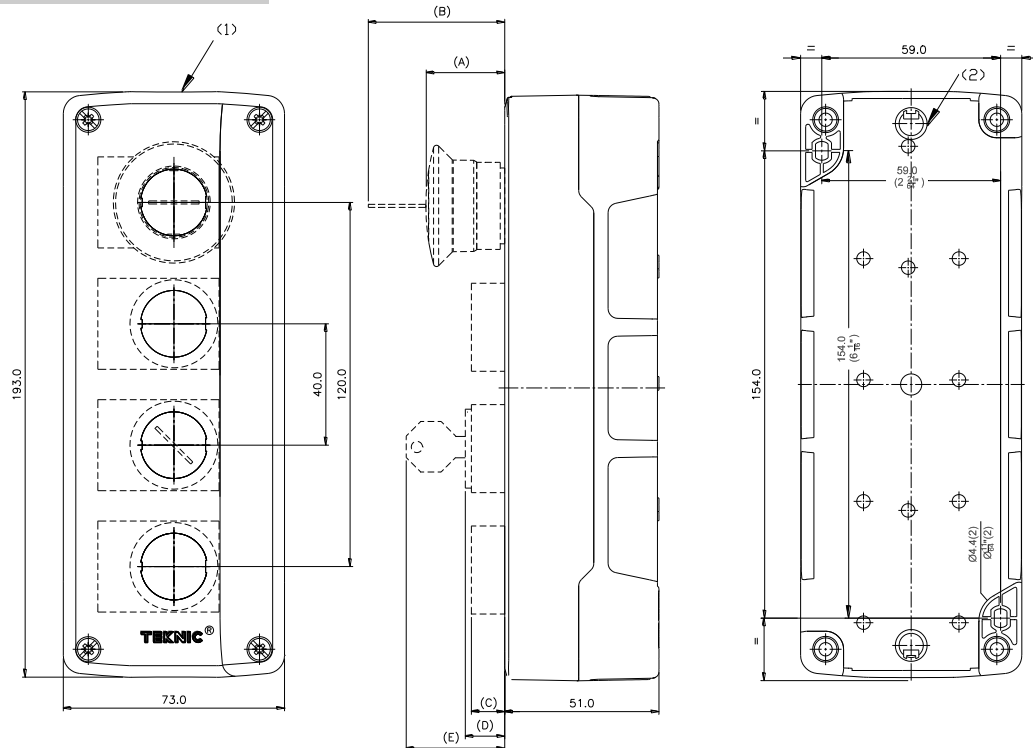

Following variations are available in 4way empty enclosure

Sr. No.	Color of cover	Color of housing	Product code	Remarks
1	White	Black	4003G11	PC
2	Yellow	Black	4004G10	PC
3	White	Black	4005G11	ABS
4	Yellow	Black	4006G10	ABS
5	Grey	Grey	4007G17	ABS

- (1) 2 Nos of knockout for PG13.5 cable gland, maximum capacity 12mm
- (2) 2 Nos of Knockout for cable entry, max capacity 10mm
- (A) 51mm (max) for non-illuminated, latching, mushroom head Emergency Stop pushbutton  
48mm (max) for non-illuminated, latching, mushroom head, key operated, Emergency Stop pushbutton (with key removed)  
72mm (max) for non-illuminated, latching, mushroom head, key operated, Emergency Stop pushbutton (with key inserted)
- (B) 15mm (max) for Pilot light (Model 4PL...)
- (C) 27mm (max) for illuminated rotary pushbuttons (Model P4PSSL...)  
19mm (max) for illuminated flush/projecting pushbuttons (Model P4PSFL.../P4PSPL...)  
15mm (max) for illuminated twin headed pushbutton (Model P4PST...)  
25mm (max) for non-illuminated rotary selector pushbutton (Model P4PSS...)  
15mm (max) for non-illuminated twin headed pushbutton (Model P4PST...)  
12mm (max) for non-illuminated flush pushbutton (Model P4PSF...)  
20mm (max) for non-illuminated projecting pushbutton (Model P4PSP...)
- (D) 21mm (max) for non-illuminated Key selector (in key removed position) (Model P4PSK...)
- (E) 45mm (max) for non-illuminated Key selector (in key inserted position) (Model P4PSK...)
- (F) 30mm (max) for mono-block, non-illuminated, mushroom head, latching type (Model 3PSM...)  
25mm (max) for mono-block, non-illuminated selector, standard handle (Model 3PSS...)  
15mm (max) for mono-block, non-illuminated, flush pushbutton (Model 3PSF...)  
15mm (max) for mono-block, pilot light (Model 3PL...)

#### Dimensions (Contd.)

#### 5way

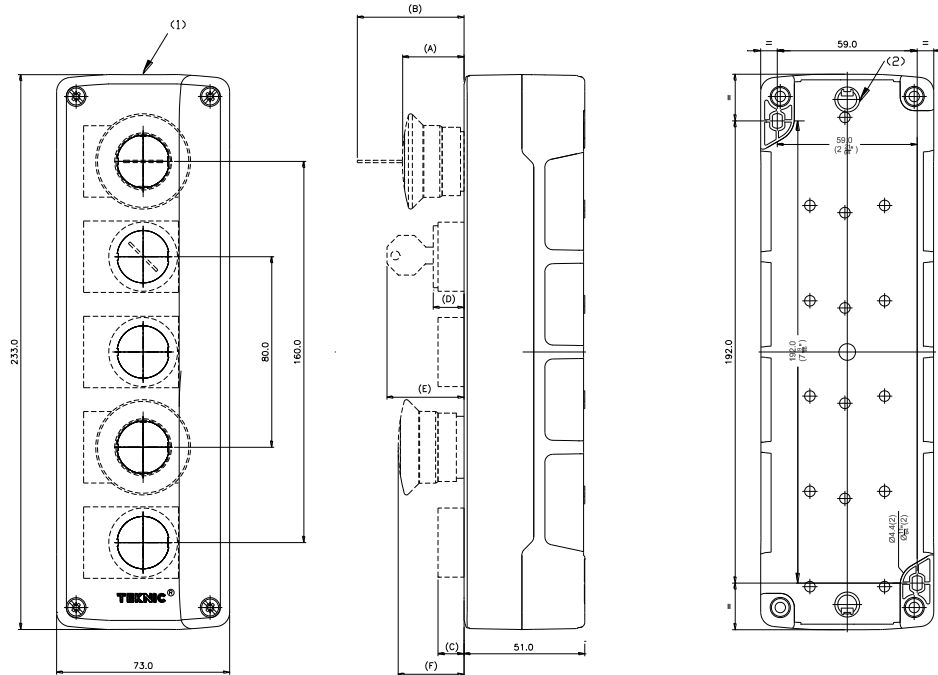

Following variations are available in 5way empty enclosure

Sr. No.	Color of cover	Color of housing	Product code	Remarks
1	White	Black	4003S11	PC
2	Yellow	Black	4004S10	PC
3	White	Black	4005S11	ABS
4	Yellow	Black	4006S10	ABS
5	Grey	Grey	4007S17	ABS

- (1) 2Nos of knockout for PG13.5 cable gland, maximum capacity 12mm  
 (2) 2Nos. of Knockout for cable entry, max capacity 10mm  
 (A) 51mm (max) for non-illuminated, latching, mushroom head Emergency Stop pushbutton  
 48mm (max) for non-illuminated, latching, mushroom head, key operated, Emergency Stop pushbutton (with key removed)  
 (B) 72mm (max) for non-illuminated, latching, mushroom head, key operated, Emergency Stop pushbutton (with key inserted)  
 (C) 15mm (max) for Pilot light (Model 4PL...)  
 27mm (max) for illuminated rotary pushbuttons (Model P4PSSL...)  
 19mm (max) for illuminated flush/projecting pushbuttons (Model P4PSFL.../P4PSPL...)  
 15mm (max) for illuminated twin headed pushbutton (Model P4PST...)  
 25mm (max) for non-illuminated rotary selector pushbutton (Model P4PSS...)  
 15mm (max) for non-illuminated twin headed pushbutton (Model P4PST...)  
 12mm (max) for non-illuminated flush pushbutton (Model P4PSF...)  
 20mm (max) for non-illuminated projecting pushbutton (Model P4PSP...)  
 (D) 21mm (max) for non-illuminated Key selector (in key removed position) (Model P4PSK...)  
 (E) 45mm (max) for non-illuminated Key selector (in key inserted position) (Model P4PSK...)  
 (F) 30mm (max) for mono-block, non-illuminated, mushroom head, latching type (Model 3PSM...)  
 25mm (max) for mono-block, non-illuminated selector, standard handle (Model 3PSS...)  
 15mm (max) for mono-block, non-illuminated, flush pushbutton (Model 3PSF...)  
 15mm (max) for mono-block, pilot light (Model 3PL...)

#### Dimensions (Contd.)

#### 6way

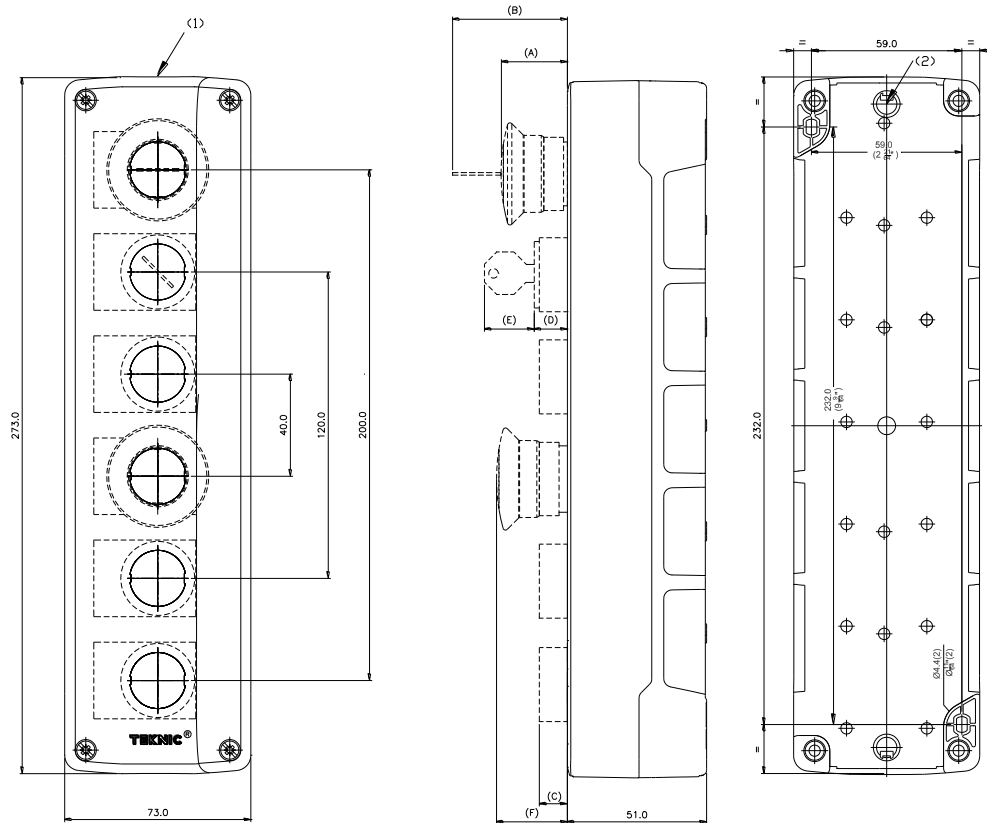

Following variations are available in 6way empty enclosure

Sr. No.	Color of cover	Color of housing	Product code	Remarks
1	White	Black	4003I11	PC
2	Yellow	Black	4004I10	PC
3	White	Black	4005I11	ABS
4	Yellow	Black	4006I10	ABS
5	Grey	Grey	4007I17	ABS

#### Special purpose stations

For special purpose stations, kindly contact TEKNIC

Sr. No.	Color of cover	Color of housing	Product code	Remarks
1	Yellow	Black	4008I10	ABS (Elevator function)

- (1) 2 Nos of knockout for PG13.5 cable gland, maximum capacity 12mm  
 (2) 2 Nos. of Knockout for cable entry, max capacity 10mm  
 (A) 51mm (max) for non-illuminated, latching, mushroom head Emergency Stop pushbutton  
 48mm (max) for non-illuminated, latching, mushroom head, key operated, Emergency Stop pushbutton (with key removed)  
 (B) 72mm (max) for non-illuminated, latching, mushroom head, key operated, Emergency Stop pushbutton (with key inserted)  
 (C) 15mm (max) for Pilot light (Model 4PL...)  
 27mm (max) for illuminated rotary pushbuttons (Model P4PSSL...)  
 19mm (max) for illuminated flush/projecting pushbuttons (Model P4PSFL.../P4PSPL...)  
 15mm (max) for illuminated twin headed pushbutton (Model P4PST...)  
 25mm (max) for non-illuminated rotary selector pushbutton (Model P4PSS...)  
 15mm (max) for non-illuminated twin headed pushbutton (Model P4PST...)  
 12mm (max) for non-illuminated flush pushbutton (Model P4PSF...)  
 20mm (max) for non-illuminated projecting pushbutton (Model P4PSP...)  
 (D) 21mm (max) for non-illuminated Key selector (in key removed position) (Model P4PSK...)  
 (E) 45mm (max) for non-illuminated Key selector (in key inserted position) (Model P4PSK...)  
 (F) 30mm (max) for mono-block, non-illuminated, mushroom head, latching type (Model 3PSM...)  
 25mm (max) for mono-block, non-illuminated selector, standard handle (Model 3PSS...)  
 15mm (max) for mono-block, non-illuminated, flush pushbutton (Model 3PSF...)  
 15mm (max) for mono-block, pilot light (Model 3PL...)

#### Assembly with Clip-on Pilot lights (Model 4PL..)

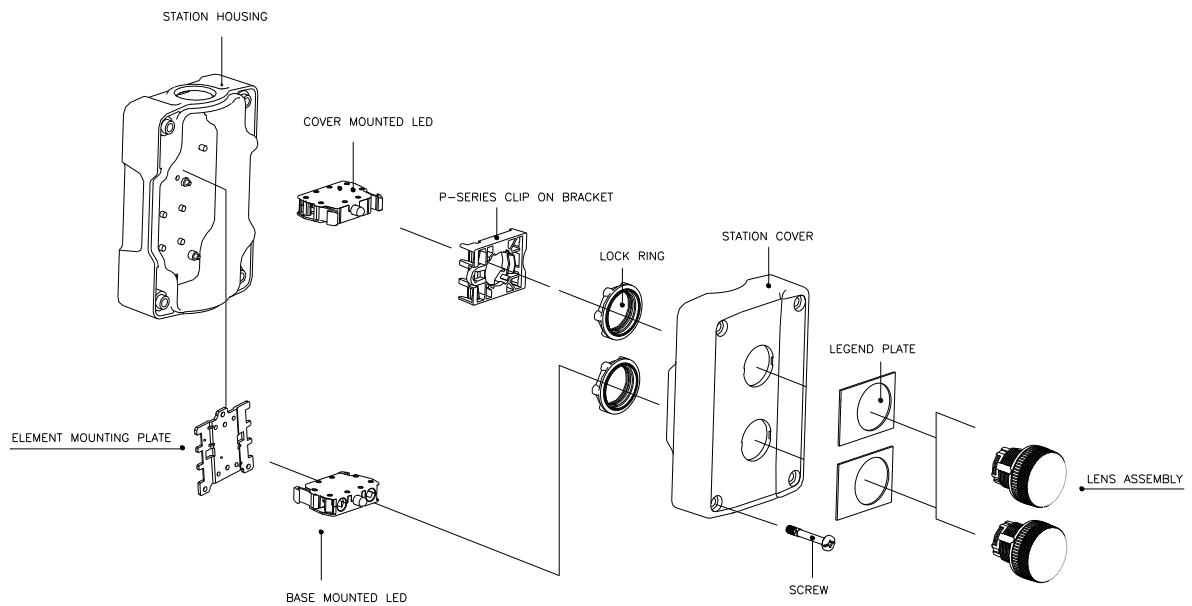

Note: For ordering our 4PL... series pilot light, please refer our attached Specification Sheet for Clip-on LED Pilot light

#### Assembly with Illuminated Actuators Model P4PS... (with Clip on elements)

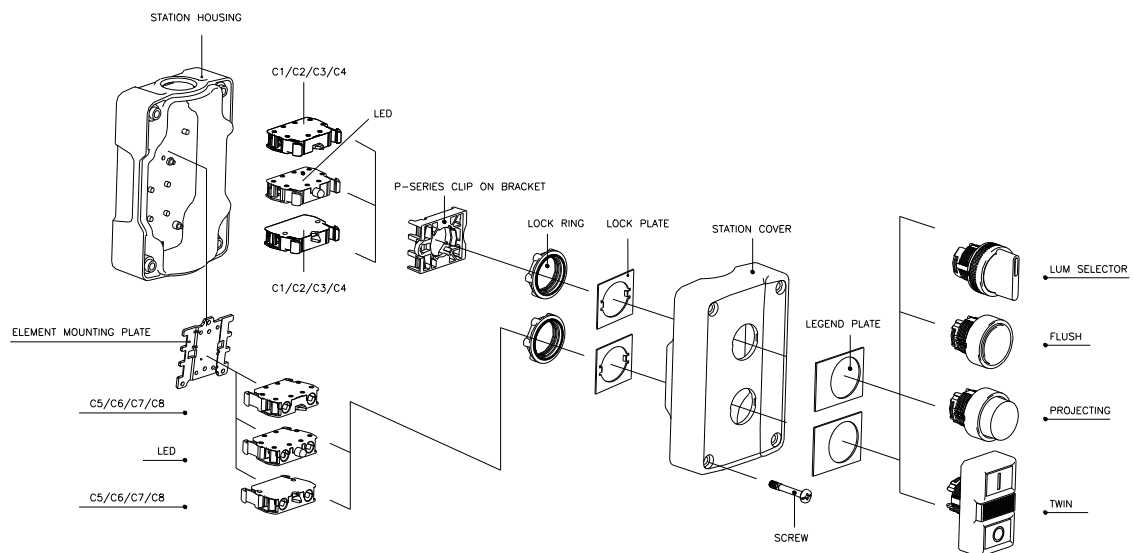

Note: For ordering our P4PS... pushbuttons, please refer our attached Specification Sheet for P4PS... series pushbutton

#### Assembly with Non-Illuminated Actuators (Rotary, Twin headed & Mushroom Stayput) Model P4PS...(with Clip-on elements)

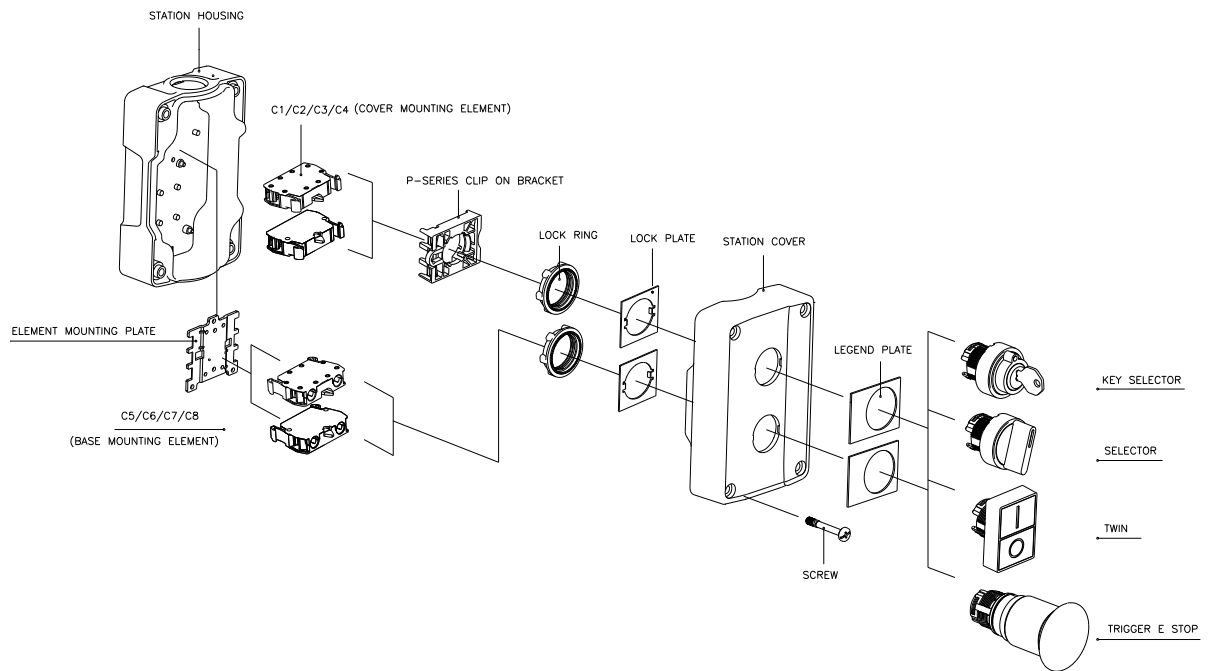

**Note:** For ordering our P4PS... pushbuttons, please refer our attached Specification Sheet for P4PS... series pushbutton

#### Assembly with Non-Illuminated Actuators (Spring Return) Model P4PS...(with Clip-on elements)

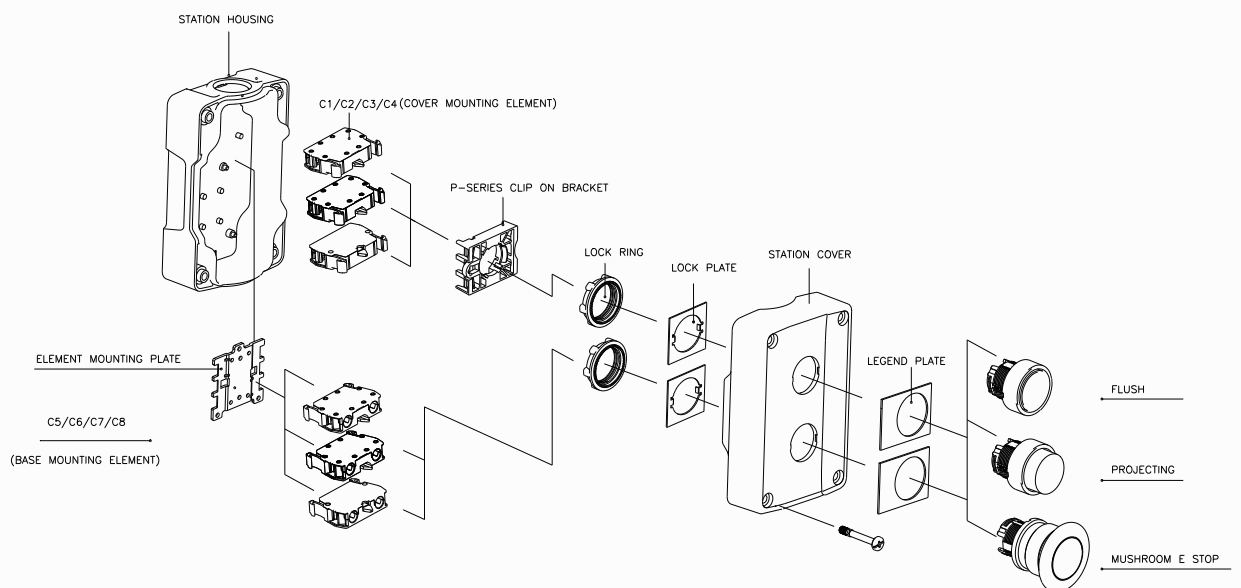

**Note:** For ordering our P4PS... pushbuttons, please refer our attached Specification Sheet for P4PS... series pushbutton



#### Assembly with Non-Illuminated Actuators (Spring return, Rotary, Twin headed & Mushroom Stayput) Model P2PS...with S... series contact elements

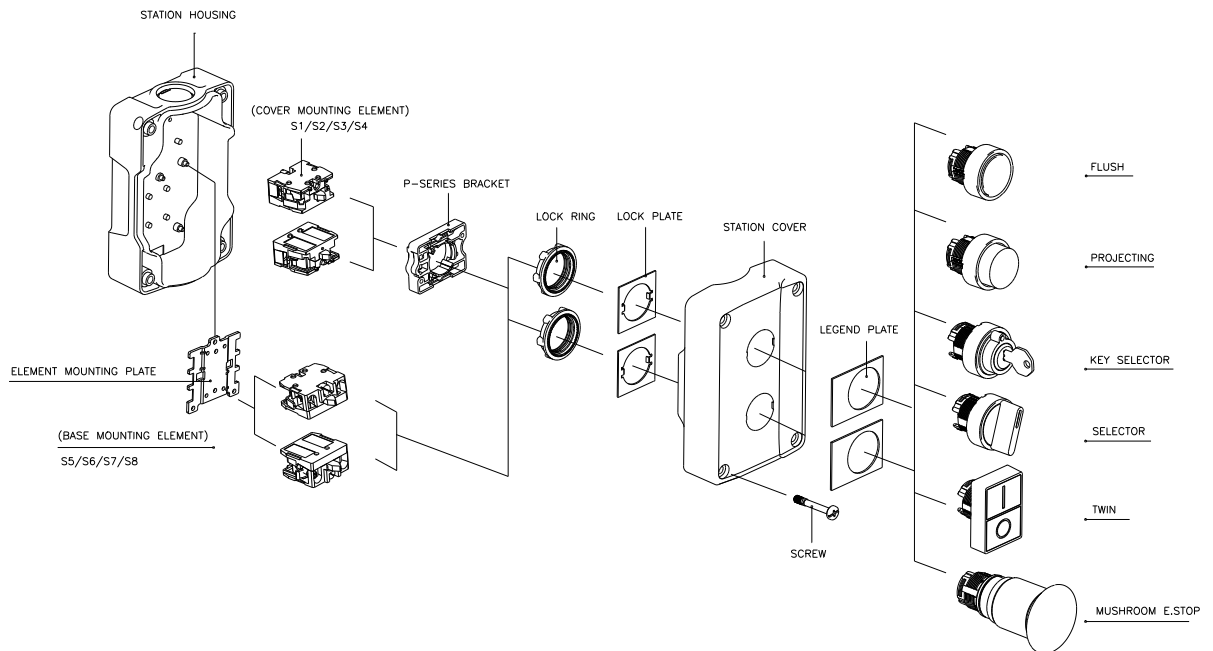

**Note:** For ordering our P2PS... pushbuttons, P2PL...pilot lights & P2AF...actuators, please refer our Plastic series Control & Signaling Devices Catalogue.

#### Assembly with Pilot light (P2PL... series)

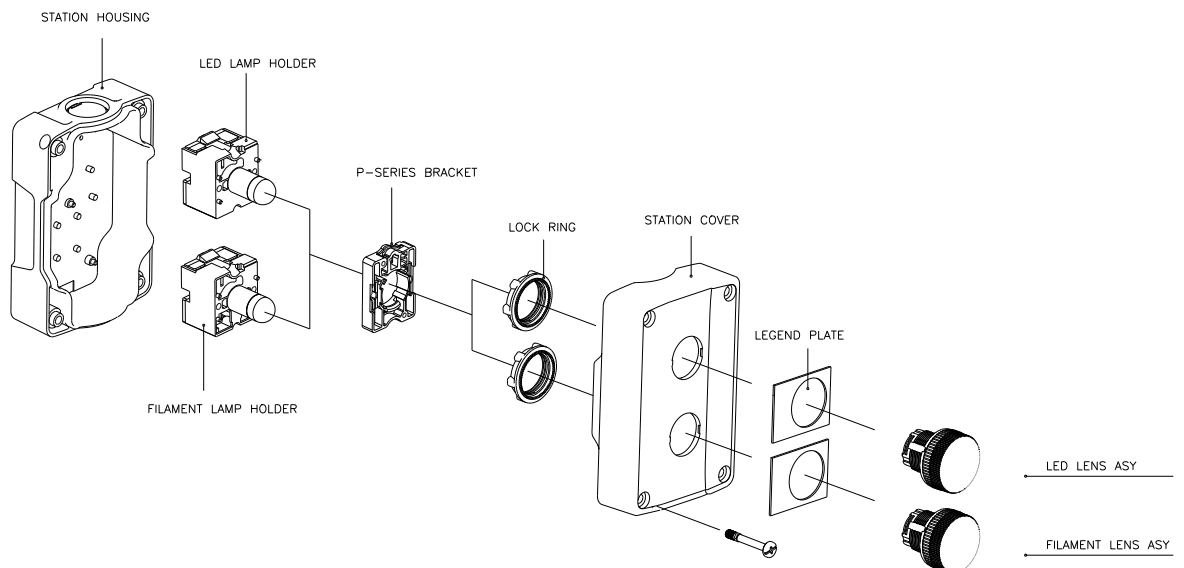

**Note:** For ordering our P2PS... pushbuttons, P2PL...pilot lights & P2AF...actuators, please refer our Plastic series Control & Signaling Devices Catalogue.

#### Assembly with 103 series Mono-block pushbutton (Model 3PS...) & Pilot Light (Model 3PL...)

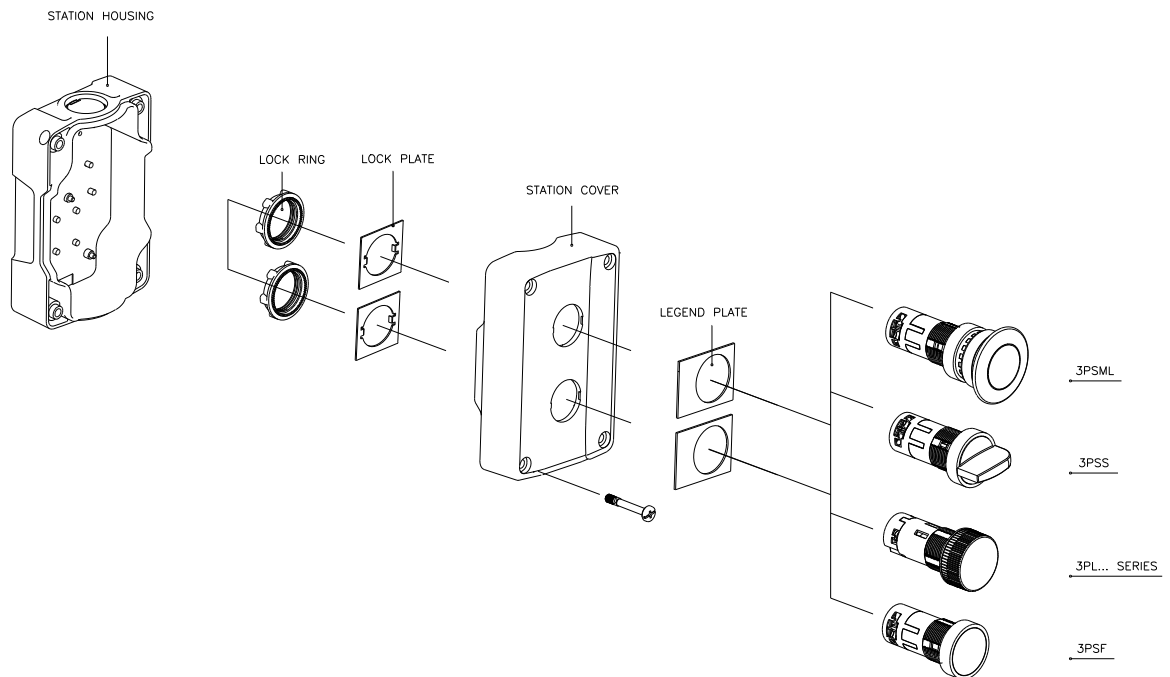

**Note:** For ordering our Mono-block pushbuttons (Model 3PS...) & Pilot lights (Model 3PL...), please refer attached specification sheet for 3PS... series pushbuttons & specification sheet for 3PL... series pilot light

Contact Function Characteristics			
		S... series contact elements	C-series Clip-on elements
Rated operational characteristics (conforming to IEC/EN 60947-5-1)		AC15: 415VAC, 4A DC13: 0.5A, 110VDC As per CSA C22.2 no. 14-05, UL 508: A600, Q600	
Rated impulse withstand voltage		500V	
Electrical rating	For 1 million operation cycles, operation at 3600 cycles per hour, load factor 0.5	AC15 V 24 120 230 A 4 3 2 DC13 V 24 110 A 0.5 0.2	Under Test
Mechanical durability	(In million of operating cycles)	1	
Contact operation	NC or NO	Slow break	
Positive operation	Conforming to IEC/EN 60947-5-1 Appendix K	All functions incorporating a NC contact are positive opening operation	
Terminal capacity	Conforming to IEC/EN 60947-1	Screw clamp terminals Min. 1X0.5mm <sup>2</sup> Max. 2X1.5mm <sup>2</sup> or 1X2.5mm <sup>2</sup> Tightening torque: 1Nm max	
Contact material		Silver Nickel (Ag-Ni)	
Nominal thermal current	Conforming to IEC/EN 60947-5-1	10A	
Short circuit protection	-do-	10A cartridge fuse HRC type, rated for resistive loading	
Rated insulation voltage	-do-	500V	

Pushbutton Characteristics (P2PS... series)		
Mechanical durability (in million of operating cycles)	Spring return pushbutton	1
	Non illuminated selector switch	1
	Illuminated selector switch	0.1
	Emergency stop pushbutton	0.1
Vibration resistance	Conforming to IEC 60068-2-6	All functions (except mushroom & selectors): 15g acceleration; frequency 40-500Hz. For Mushroom: 8g acceleration; frequency 40-500Hz For Selectors: 15g acceleration; frequency 40-500Hz
Shock resistance	Conforming to IEC 60068-2-27	All functions (except mushroom & selectors): 3 shocks at 70g acceleration & 6ms; total 18 shocks. For mushroom: 3 shocks at 15g acceleration & 11ms; total 18 shocks. For selectors: 3 shocks at 200g acceleration; frequency 40-500Hz)

#### SPECIFICATION SHEET FOR 3PS... SERIES PUSHBUTTONS

##### Mechanical Durability

Push Button	Spring Return	Million Operations	1
	Selector		1
	Latching Type		0.02

##### Standards & Conditions

Applicable Standard	UL508 IEC 60947-5-1 CSA 22.2
Degree Of Protection	IP65 (as per IEC 60947-5-1)
Operating Conditions	+70° to -25°C
Mounting	Confirming to IEC 60947-5-1 Finished fixing hole :22.5mm recommended (22.3+0.4/0) Fixing Centers: 30*40 mm Min. (Unless otherwise indicated) Mounting Panel thickness:1 to 6 mm

##### Electrical Characteristics

Rating		<b>For AC:</b> <b>C300</b> = 120V, make current 15A & break current 1.5A (Thermal current=2.5A) <b>&amp; For DC:</b> <b>R300</b> = 125V, make or break current 0.22A (Thermal current=1.0A)
Type of contact		N/C or N/O or C/O Slow Break
Positive operation		All functions incorporating an N/C contact have positive opening
Terminal Capacity	Cabling	2 X 1.5mm <sup>2</sup> 1 X 0.5mm <sup>2</sup> (min) 1 X 2.5mm <sup>2</sup> (max)
Screw Clamp tightening torque		0.8 N.m to 1Nm (max) Screw head compatible with Posidrive or Phillips screw driver.
Short Circuit Protection		4A (gG cartridge fuse)
Rated Thermal Current		4A
Rated insulation Voltage		Ui = 250V (Degree of pollution 3)
Rated impulse withstand voltage		Uimp = 6kV
Dielectric Test		2.5KV
Rated insulation Resistance		500MΩ

#### Ordering codes for 3PS... Mono-block series non-illuminated pushbuttons

<u>3</u>	<u>PS</u>	<u>#</u>	<u>X</u>	<u>YY</u>	<u>-2P/3P</u>
↓	↓	↓	↓	↓	↓
Indicates mono-block series	Indicates pushbutton switch	<ul style="list-style-type: none"> <li>Can be <b>F</b> if the pushbutton is flush</li> <li>Can be <b>M</b> if the pushbutton is mushroom</li> <li>Can be <b>S</b> if the pushbutton is selector</li> </ul>	Denotes colour of pushbutton as follows: <ul style="list-style-type: none"> <li>1=white</li> <li>2=Black</li> <li>3=Green</li> <li>4=Red</li> <li>6=Blue</li> <li>8=Yellow</li> </ul>	Denotes No. of Contact Elements attached to the Push Button. <ul style="list-style-type: none"> <li>1st "Y" indicates no. of (NO) Contact elements</li> <li>2nd "Y" indicates no. of (NC) Contact elements</li> </ul>	Applicable for selectors <ul style="list-style-type: none"> <li>2P=2Position</li> <li>3P=3Position</li> </ul>

#### SPECIFICATION SHEET FOR 3PL... SERIES PILOT LIGHTS

Mechanical Characteristics		
Standard	Applicable	UL508 IS13947-5-1 CSA 22.2
Degree Of Protection		IP65 (as per IS 13947), 4X, 12 as per UL50
Operating Conditions		+70° to -25°C
Corrosion protection		All metallic parts are electroplated for corrosion protection
Terminal Torque		0.8Nm to 1Nm (max)
Viewing Angle		More than 100°
Optical Axial intensity		More than 100mcd for all colors
Electrical Characteristics		
Rating		Rated 6V AC/DC to 240V AC and 220V DC, 2W max. (Integral LEDs)
Terminal Capacity		Cabling 2 X 1.5mm <sup>2</sup> 1 X 0.5mm <sup>2</sup> (min) 1 X 2.5mm <sup>2</sup> (max)
Dielectric Test		2.5KV
Rated insulation Resistance		500MΩ at 1000VDC
Polarity protection		Polarity protection is only in case of DC supply lamps
Low voltage protection		20V for 110V AC & 110V DC 40V for 240V AC & 220V DC (i.e. approx. 20% of Rated Voltage)
Current Consumption		Max. 20mA for AC circuits Max. 15mA for DC circuits

#### Ordering codes for 3PL... Mono-block series Pilot Lights

<u>3</u>	<u>PLBR</u>	<u>X</u>	<u>L</u>	<u>S</u>	<u>ZZZ</u>
↓	↓	↓	↓	↓	↓
Indicates mono-block series	Indicates Pilot light with resistor	Denotes color of Pilot light as follows: <ul style="list-style-type: none"> <li>1=white</li> <li>3=Green</li> <li>4=Red</li> <li>5=Amber</li> <li>6=Blue</li> <li>7=Clear</li> <li>8=Yellow</li> </ul>	LED	Special (Fluorescent)	Rated voltage from 6VAC/DC to 220VDC & 240VAC

#### SPECIFICATION SHEET CLIP-ON SERIES PILOT LIGHTS (Model 4PL...)

##### Mechanical Characteristics

Conformity to standards	Applied for testing as per UL508, IS13947-5-1& CSA 22.2
Degree Of Protection	Applied for IP65 (as per IS 13947), 4X, 12 as per UL50
Operating Conditions	+70° to -25°C
Corrosion protection	All metallic parts are electroplated for corrosion protection
Terminal Torque	0.8Nm to 1Nm (max)
Viewing Angle	More than 100°
Optical Axial intensity	More than 100mcd for all colors

##### Electrical Characteristics

Rating	Rated 110VAC & 240VAC
Terminal Capacity	Cabling 2 X 1.5mm <sup>2</sup> 1 X 0.5mm <sup>2</sup> (min) 1 X 2.5mm <sup>2</sup> (max)
Dielectric Test	2.5KV
Rated insulation Resistance	500MΩ at 1000VDC
Polarity protection	Polarity protection is only in case of DC supply lamps
Low voltage protection	20V for 110V AC 40V for 240V AC (i.e. approx. 20% of Rated Voltage)
Current Consumption	Max. 20mA for AC circuits

##### Ordering codes for 4PL... series LED Pilot Lights

<u>P4</u>	<u>PLBR</u>	<u>X</u>	<u>L</u>	<u>S</u>	<u>B</u>	<u>ZZZ</u>
Indicates Plastic 104 series	Indicates Pilot light with resistor	Denotes color of Pilot light as follows: <ul style="list-style-type: none"> <li>1=white</li> <li>3=Green</li> <li>4=Red</li> <li>5=Amber</li> <li>6=Blue</li> <li>7=Clear</li> <li>8=Yellow</li> </ul>	LED	Special (Fluorescent)	For base mounting type	Rated voltage from 6VAC/DC to 220VDC & 240VAC

#### SPECIFICATION SHEET P4PS...SERIES PUSHBUTTONS

##### General

P4PS...series pushbuttons consists of actuator heads (illuminated/non-illuminated) from the P2PS... series & contact blocks. Contact block may be from S... series or from C... series (clip-on type)

##### Ordering codes for P4PS... series pushbuttons

<u>P</u>	<u>4</u>	<u>PS</u>	<u>#</u>	<u>X</u>	<u>YY</u>	<u>*</u>	<u>ZZZ</u>	<u>AA</u>
↓	↓	↓	↓	↓	↓		↓	↓
Indicates Plastic series	Ø22.5 104 series	Pushbutton switch	Type of operating head e.g. F= Flush P= Projecting M= Mushroom For more details please refer our Plastic series Control & Signaling Devices Catalogue	For non-illuminated 1= white 2= Black 3= Green 4= Red 6= Blue 8= Yellow  For illuminated 1=White 3=Green 4=Red 5=Amber 6=Blue 7=Clear 8=Yellow	Denotes No. of Contact Elements attached to the Push Button.  1st "Y" indicates no of. (NO) Contact elements  2nd "Y" indicates no. of (NC) Contact elements	Denotes different execution for rotary selector/ Key selector e.g. 2P, 3P, 3PSR, 3PA, 2PO etc.	Rated voltage 110VAC & 240VAC	Code for marking on top of button e.g. IO